



Alkham Road Stoke Newington, London N16

NEXT MOVE
PROPERTY AGENTS

Alkham Road Stoke Newington London N16

Wonderfully stylish one bedroom flat set within a popular converted former church situated close to all good local amenities.

DESCRIPTION

Arranged on the second floor and boasting beautiful contemporary interiors throughout the accommodation comprises a large living room, separate kitchen with a serving hatch, smart units and integrated appliances; double bedroom; and modern shower room. There is car parking to the side of the building available on a 'first come' basis.

Ark Court is located on Alkham Road just a short stroll from Church Street and The High Street's eclectic array of eateries, independent shops, pubs and coffee bars. There are excellent transport links to The City and West End with numerous good bus routes, and trains to Liverpool Street from nearby Stoke Newington Station (Overground).

Leasehold

£325,000





Second Floor
401 sq.ft. (37.3 sq.m.) approx.

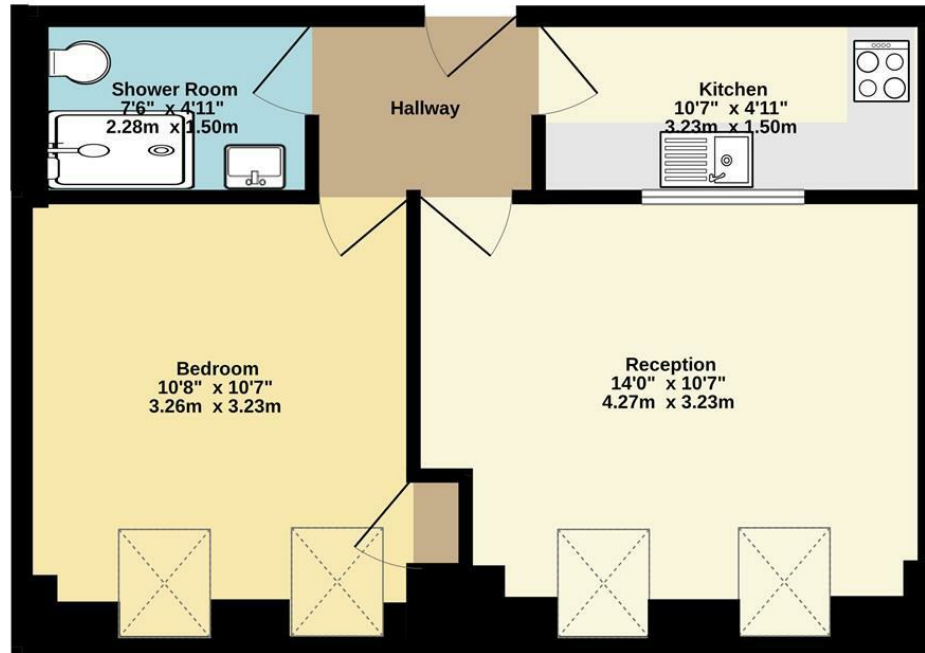

TOTAL FLOOR AREA: 401 sq.ft. (37.3 sq.m.) approx.

Whilst every attempt has been made to ensure the accuracy of the floorplan contained here, measurements of doors, windows, rooms and any other items are approximate and no responsibility is taken for any error, omission or mis-statement. This plan is for illustrative purposes only and should be used as such by any prospective purchaser. The services, systems and appliances shown have not been tested and no guarantee as to their operability or efficiency can be given.

Made with Metropix ©2023



Energy Efficiency Rating		
	Current	Potential
Very energy efficient - lower running costs		
(92 plus) A		
(81-91) B		
(69-80) C		
(55-68) D		
(39-54) E		
(21-38) F		
(1-20) G		
Not energy efficient - higher running costs		
England & Wales		EU Directive 2002/91/EC

NEXT MOVE
PROPERTY AGENTS

n16@nextmove.com
020 7254 9709
63-65 Stoke Newington Church Street,
London N16 0AR

nextmove.com